

INSTALL FX LUMINAIRE  
MULLUSCO MURO USING 16  
GAUGE CABLE AND PROVIDED  
WIRE NUTS. MOUNT 8"–12" OFF  
FINISHED GRADE.

THE FX LUMINAIRE MULLUSCO  
MURO SHROUD DIAMETER IS 2.33".

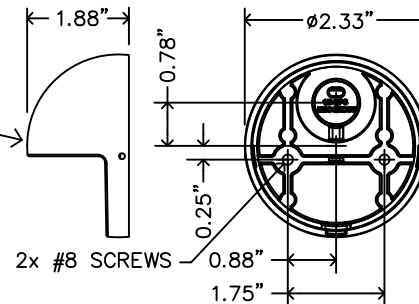

WOODEN WALL  
MOUNTING HARDWARE PROVIDED  
WITH MULLUSCO MURO.

THE FX MULLUSCO MURO  
INCORPORATES AN ADJUSTABLE  
LAMP SHROUD FOR FIELD LEVEL  
ADJUSTMENT, 10 WATT MAXIMUM  
LAMP.

THIS FIXTURE IS DESIGNED  
FOR DOWN LIGHTING ONLY.  
DO NOT USE IN UP LIGHT  
POSITION.

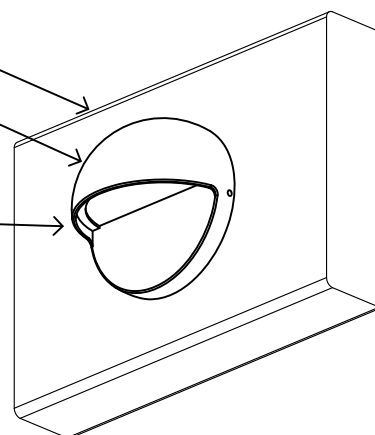

SECTION/ELEVATION

MULLUSCO MURO(MM)  
WOOD WALL MOUNT

XX

NOT TO SCALE

FX LUMINAIRE DETAIL