

INSTALL FX LUMINAIRE MICROLITE USING 16 GAUGE CABLE AND PROVIDED WIRE NUTS.  
COMPOSITE HOUSING CAN BE DRILLED FOR 1/2" CONDUIT TUBING USING A 7/8" HOLE SAW.

THE FX LUMINAIRE MICROLITE INCORPORATES AN ADJUSTABLE LAMP BRACKET FOR VARIABLE BEAM ANGLE, 20 WATT MAXIMUM LAMP.

WATERPROOF SLEEVE END TO PREVENT WATER FROM SEEPING THROUGH THE WALL INTO THE LAMP HOUSING. LEAVE 12" SERVICE LOOP COILED INSIDE THE SLEEVE.

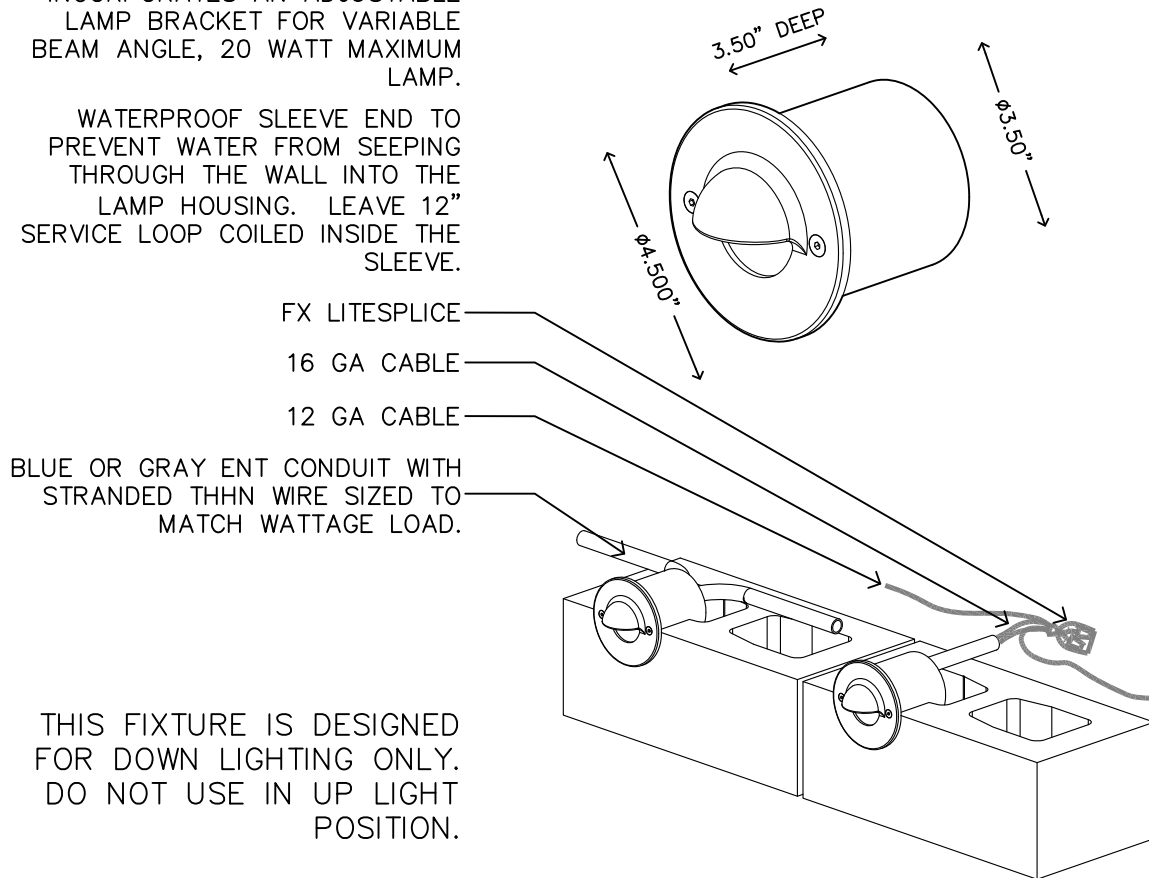

SECTION/ELEVATION

XX MICROLITE(ML)  
CONCRETE WALL MOUNT

NOT TO SCALE

FX LUMINAIRE DETAIL