

STANDARD | SURFACE-MOUNTED WALL LIGHT | MM

Replacement Parts

ITEM	DESCRIPTION	PART #
1	Faceplate, Lens, and Screws	MM-FP-XX*
2	Screw, #8-32 x 1/8"	250010320000
3	Reflector	†
4	Lamp, G4	See Lamp Chart
5	Socket, 10' (3 m)	754601
6	Housing	†
NS	Hex Key, 5/64"	250010330000

NS = Not shown

*XX = Finish code

† This part is not serviceable. Contact Customer Support or a local distributor to order a replacement product.

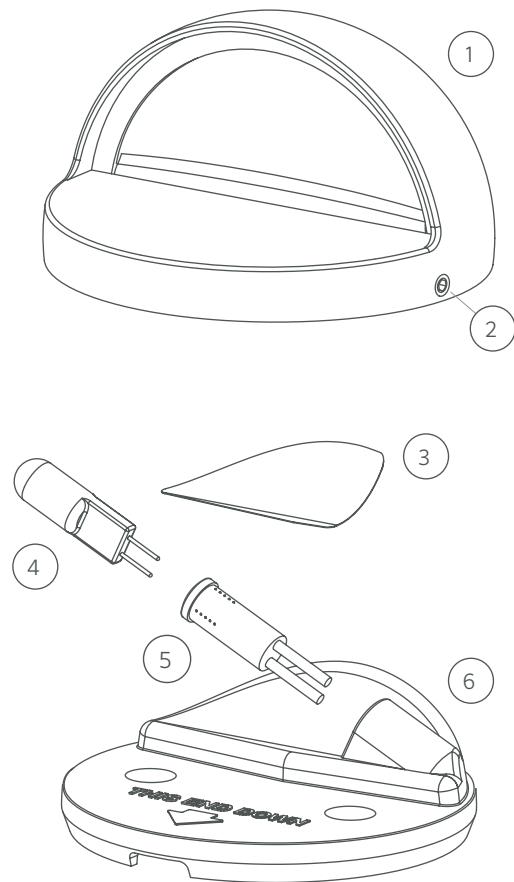

LAMPS | G4 LAMPS

G4 LED Lamp Chart

LUMENS / VA	CCT	PART #
1.0 VA / 75 lm	2700K	G4-E-1-W
1.3 VA / 120 lm	2700K	G4-E-2-W
1.7 VA / 170 lm	2700K	G4-E-3-W
1.0 VA / 80 lm	3000K	G4-E-1-S
1.3 VA / 130 lm	3000K	G4-E-2-S
1.7 VA / 190 lm	3000K	G4-E-3-S

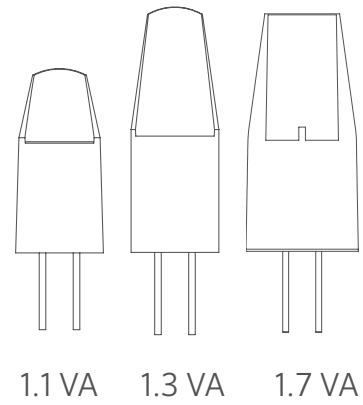

fxl.com/G4