

Replacement Parts

ITEM	DESCRIPTION	PART #
1	Screw, #8-32 x 1½"	250021670000
2	Faceplate, Lens, and Gasket	†
1-2	Faceplate Assembly	UN-FP-XX*
3	Screw, #8-32 x ¾"	250013070000
4	Color Filter, Amber	250015770000‡
5	Screw	See LED Chart
6	LED Board	See LED Chart
7	Socket, 10' (3 m)	†
8	Reflector	250015750000
9	Screw, #8-32 x 2"	250013080000
10	Inner Box	†
3-10	LED Retrofit Kit	CP-LED-RETRO
11	Sleeve Protector	†
12	Outer Sleeve	†
11-12	Sleeve and Protector Assembly	250022040000
NS	Hex Key, ⅜" Long Arm	250013120000

NS = Not shown  
\*XX = Finish code  
† This part is not serviceable. Contact Customer Support or a local distributor to order a new product.  
‡ Available with the CP-LED-RETRO Kit

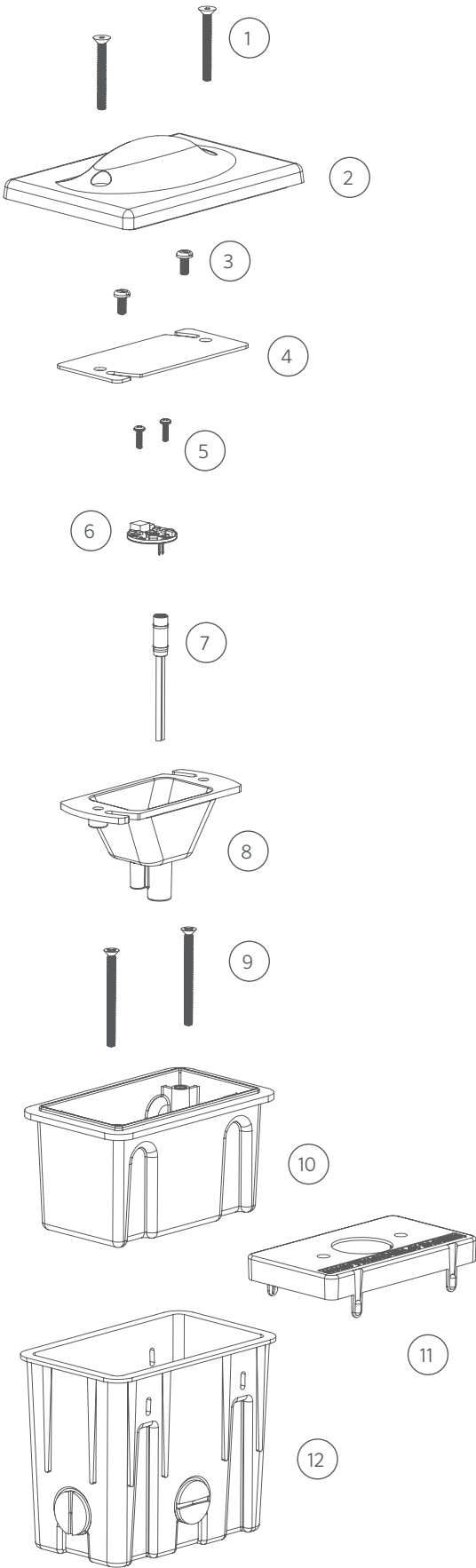

DESIGNER | ROUND BOARDS WITH BEAM ANGLE LENSES, 1 LED

2nd Gen LED Chart

DESCRIPTION	PART #
<b>LED Replacement Kits</b> (Board, Reflector, Screws, Beam Angle Lenses)	
1 LED Up Light Kit (2700K)	KIT-1LED-RD-W
ZD 1 LED Up Light Kit (2700K)	KIT-ZD-1LED-RD-W
<b>Reflectors</b>	
1 LED Reflector	770000
<b>Screws</b>	
1 LED/3 LED Screw, #4-40 x 3/8" (Qty Req: 2)	762400

Beam Angle Lens Chart

DESCRIPTION	PART #
<b>Round Beam Angle Lenses</b>	
1 LED Spot Lens (20°)	770600
1 LED Flood Lens (35°)	1LED-FL-LENS
1 LED Wide Flood Lens (60°)	1LED-WFL-LENS

1st Gen LED Chart

DESCRIPTION	PART #
<b>LED Replacement Kits</b> (Board, Reflector, Screws, Color Filters)	
1 LED Up Light Kit (3900K)	1LED-UL-KIT
ZD 1 LED Up Light Kit (3900K)	ZD-1LED-UL-KIT
<b>Color Filter Lenses Only</b>	
1 LED Color Filter, Amber	770100
1 LED Color Filter, Blue	770101
1 LED Color Filter, Green	770102
<b>Optics Kits</b> (Reflector, Screws, Color Filters)	
1 LED Optics Kit	1LED-OPTICS-KIT