

STANDARD | DIRECTIONAL ACCENT LIGHT | MP

Replacement Parts

ITEM	DESCRIPTION	PART #
1	Lens Cap Assembly	MP-LC-XX*
2	MR-11 LED Lamp	See Lamp Chart
3	Socket, MR-11 Lamp Base	250010440000
4	Spring	†
5	O-Ring	250010280015
6	Body	†
7	Knuckle	†
8	Screw, ¼"-20 x ¾"	250010290000
7-8	Knuckle Subassembly	KFM050XX*
9	Lock Ring	250030410000SP
10	Super Slot Spike	753900
11	Critter Plug	250031010000SP

*XX = Finish Code

†This part is not serviceable. Contact Customer Support or a local distributor to order a new product.

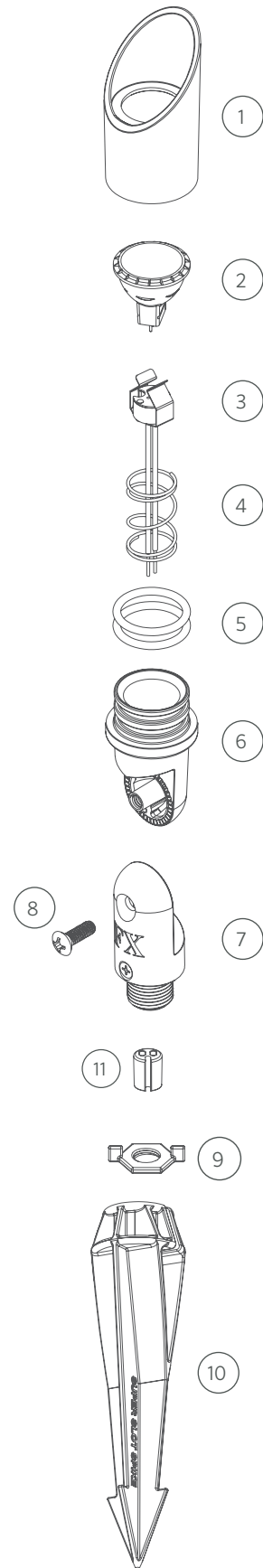

STANDARD | MR-11 LAMPS

MR-11 Eco LED Lamp Chart

LUMENS / VA	CCT	BEAM ANGLE	PART #
156 lm / 3.3 VA	2700K	35° Flood	MR11-E-4-W-FL
176 lm / 3.3 VA	3000K	35° Flood	MR11-E-4-S-FL