

STANDARD | UP LIGHT | WS

Replacement Parts

ITEM	DESCRIPTION	CATALOG #
1	Screw, SCH, #8-32 x 7/16" LG, Machine, 9/64" Hex, SST	250022400000
2	Lens, Frosted, WS	-
3	Shroud, WS	-
2-3	Lens Cap, Frosted	WSLFXX*
4	O-Ring, Silicone, Orange, -232	250010280038
5	Lamp, G4 Bi-Pin	See Lamp Chart, p. 125
6	Connector, G4, Overmolded, 10' (3 m)	754601
7	Reflector, WS	250027710000†
8	Body, WS	†
9	Knuckle Base	See Knuckle Base Chart
10	Screw, SCH, #10-24 x 3/8" LG, SST	250013940000
11	O-Ring, Silicone, Orange, -019	250010280002
12	Knuckle Fitting Subassembly	KFM050XX*
13	Screw, OVHD, 1/4"-20 x 3/4" LG, Machine, Phillips, SST, 82	250010290000
14	Critter Plug	250031010000
15	Lock Ring	250030410000
16	Super Slot Spike	753900

*XX = Finish code

†This part is not serviceable. Contact Customer Support or a local distributor to order a new product.

Knuckle Base

DESCRIPTION	CATALOG #
Knuckle Base, Bronze Metallic	252201
Knuckle Base, Desert Granite	252206
Knuckle Base, Sedona Brown	252207
Knuckle Base, Weathered Iron	252209
Knuckle Base, Black	252214
Knuckle Base, Flat White	252215
Knuckle Base, White Gloss	252216
Knuckle Base, Almond	252219
Knuckle Base, Silver	252221

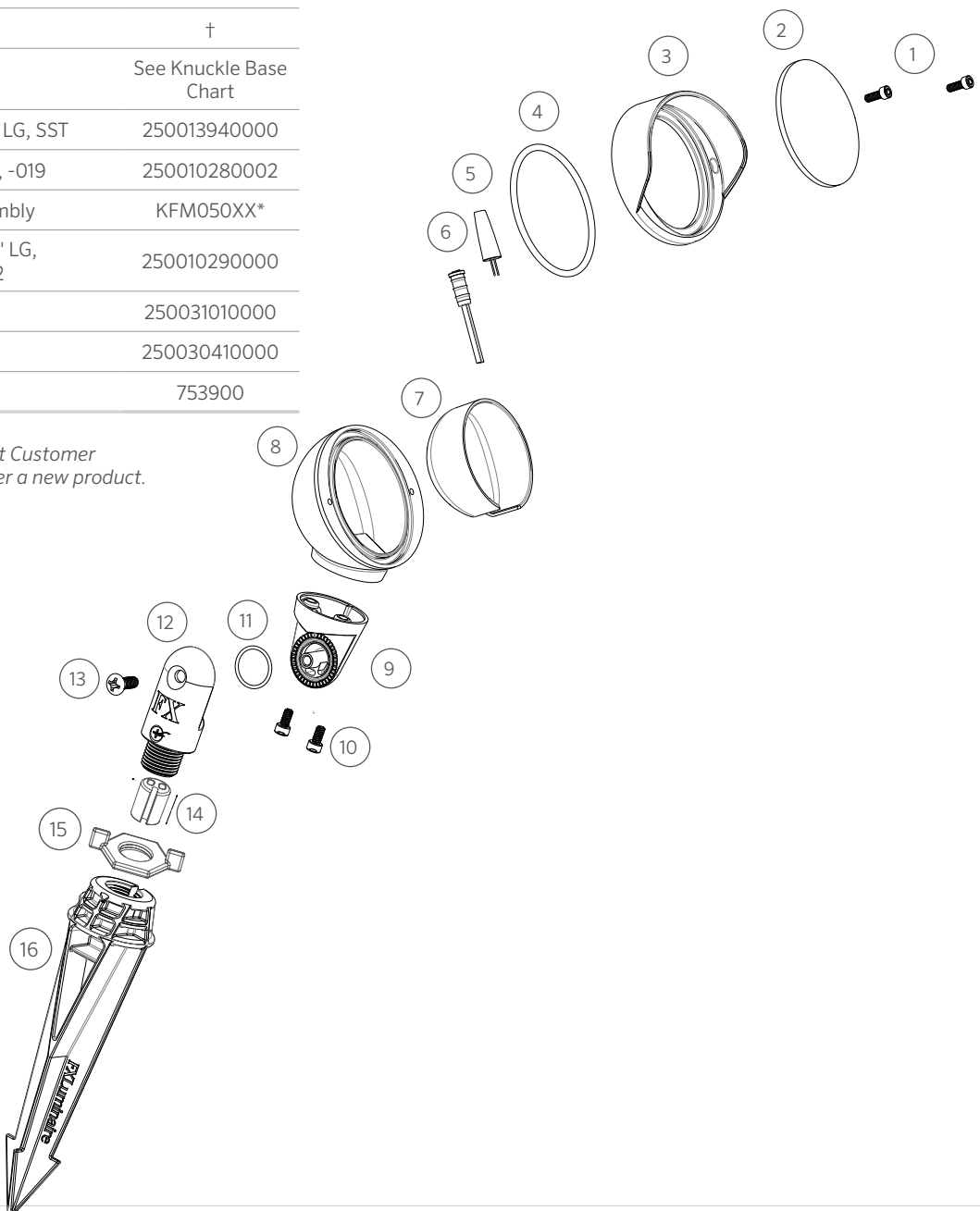

LAMPS

LED G4 Lamp Chart

DESCRIPTION	CATALOG #
Lamp, G4 LED, 10 W, 2,700K, 33,000 Hrs	G4LED10W
Lamp, G4 LED, 20 W, 2,700K, 33,000 Hrs	G4LED20 W
Lamp, G4 LED, 35 W, 2,700K, 33,000 Hrs	G4LED35 W

