

Replacement Parts

ITEM	DESCRIPTION	PART #
1	Lens Cap Assembly	QZ-LC-XX*
2	Beam Angle Lens	See LED Chart
3	Screw	See LED Chart
4	Reflector	See LED Chart
5	LED Board	See LED Chart
6	Socket, 10' (3 m)	†
7	O-Ring	250010280015
8	Body	†
9	Base	†
10	Screw, #10-24 x 3/8"	250013940000
11	Screw, 1/4"-20 x 3/4"	250010290000
12	Knuckle	†
11-12	Knuckle Subassembly	KFM-050-XX*
13	Lock Ring	250030410000SP
14	Super Slot Spike	753900

\*XX = Finish code  
†This part is not serviceable. Contact Customer Support or a local distributor to order a complete product.

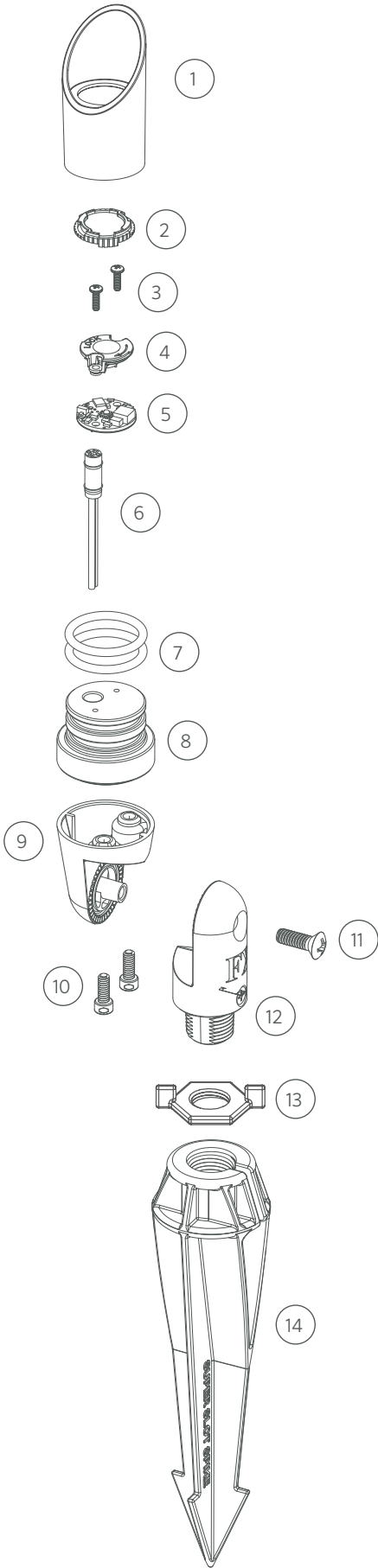

DESIGNER | ROUND BOARDS WITH BEAM ANGLE LENSES, 1 LED

2nd Gen LED Chart

DESCRIPTION	PART #
<b>LED Replacement Kits</b> (Board, Reflector, Screws, Beam Angle Lenses)	
1 LED Up Light Kit (2700K)	KIT-1LED-RD-W
ZD 1 LED Up Light Kit (2700K)	KIT-ZD-1LED-RD-W
<b>Reflectors</b>	
1 LED Reflector	770000
<b>Screws</b>	
1 LED/3 LED Screw, #4-40 x 3/8" (Qty Req: 2)	762400

Beam Angle Lens Chart

DESCRIPTION	PART #
<b>Round Beam Angle Lenses</b>	
1 LED Spot Lens (20°)	770600
1 LED Flood Lens (35°)	1LED-FL-LENS
1 LED Wide Flood Lens (60°)	1LED-WFL-LENS

1st Gen LED Chart

DESCRIPTION	PART #
<b>LED Replacement Kits</b> (Board, Reflector, Screws, Color Filters)	
1 LED Up Light Kit (3900K)	1LED-UL-KIT
ZD 1 LED Up Light Kit (3900K)	ZD-1LED-UL-KIT
<b>Color Filter Lenses Only</b>	
1 LED Color Filter, Amber	770100
1 LED Color Filter, Blue	770101
1 LED Color Filter, Green	770102
<b>Optics Kits</b> (Reflector, Screws, Color Filters)	
1 LED Optics Kit	1LED-OPTICS-KIT