

Replacement Parts

| ITEM  | DESCRIPTION                | PART #         |           |
|-------|----------------------------|----------------|-----------|
| 1     | Shroud                     | †              |           |
| 2     | Lens                       | †              |           |
| 1-2   | Lens Cap Assembly          | Clear          | FB-LC-XX* |
|       |                            | Frosted        | FB-LF-XX* |
| 3     | Beam Angle Lens            | See LED Chart  |           |
| 4     | Screw, #4-40 x 3/8"        | See LED Chart  |           |
| 5     | Reflector                  | See LED Chart  |           |
| 6     | LED Board                  | See LED Chart  |           |
| 7     | Socket, 10' (3 m)          | †              |           |
| 8     | O-Ring                     | 250010280039   |           |
| 9     | Body                       | †              |           |
| 10    | Base                       | †              |           |
| 11    | Screw, #10-24 x 3/8"       | 250013940000   |           |
| 12    | Screw, 1/4"-20 x 3/4"      | 250010290000   |           |
| 13    | Knuckle                    | †              |           |
| 12-13 | Knuckle Subassembly        | KFM-050-XX*    |           |
| 14    | Lock Ring                  | 250030410000SP |           |
| 15    | Super Slot Spike           | 753900         |           |
| 16    | Stainless Steel Bracket    | 250026820000   |           |
| 17    | Strain Relief Connector    | 250026840000   |           |
| 18    | Bracket Mount Knuckle Base | †              |           |
| 16-18 | Bracket Mount Assembly     | BM-050-XX*     |           |

\*XX = Finish code

†This part is not serviceable. Contact Customer Support or a local distributor to order a complete product.

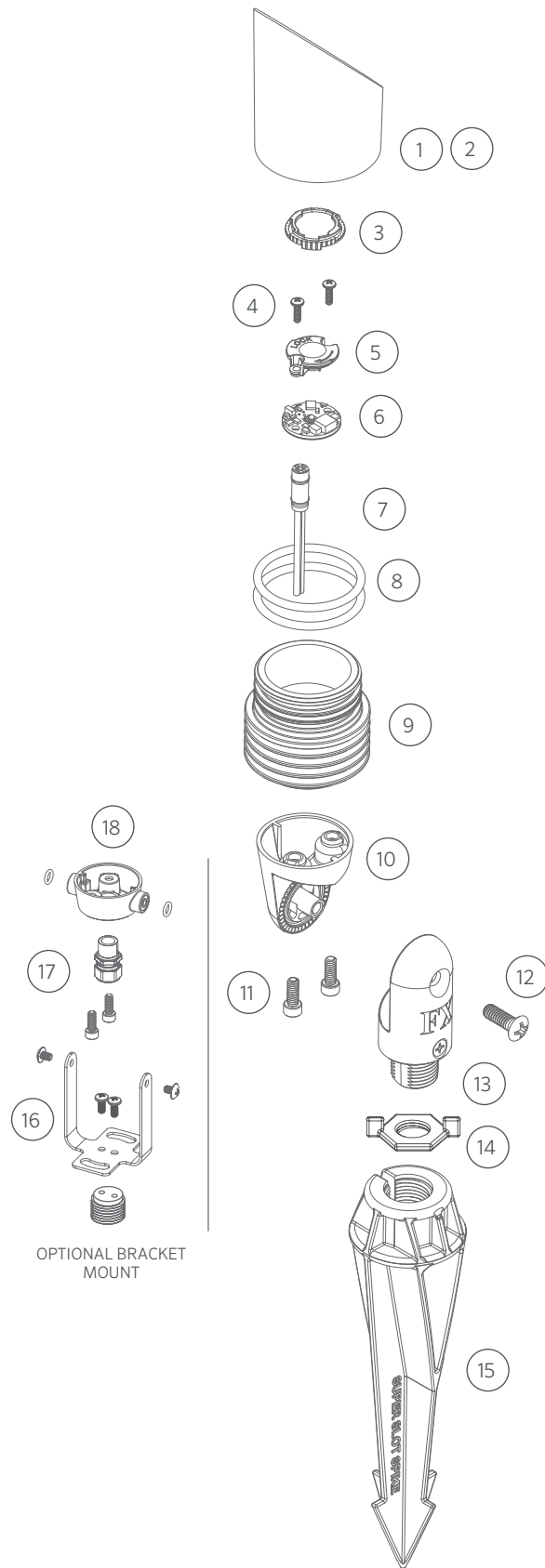

OPTIONAL BRACKET MOUNT

## DESIGNER | ROUND BOARDS WITH BEAM ANGLE LENSES, 1/3 LED

### 2nd Gen LED Chart

| DESCRIPTION   | PART #           |
|---|------------------|
| <b>LED Replacement Kits</b> (Board, Reflector, Screws, Beam Angle Lenses) |                  |
| 1 LED Up Light Kit (2700K)  | KIT-1LED-RD-W    |
| 3 LED Up Light Kit (2700K)  | KIT-3LED-RD-W    |
| ZD 1 LED Up Light Kit (2700K)   | KIT-ZD-1LED-RD-W |
| ZD 3 LED Up Light Kit (2700K)   | KIT-ZD-3LED-RD-W |
| ZDC 3 LED Kit, Medium   | ZDC-KIT-M        |
| <b>Reflectors</b>   |                  |
| 1 LED Reflector   | 770000           |
| 3 LED Reflector   | 770700           |
| ZDC 3 LED Reflector, Medium   | 250022050000     |
| <b>Screws</b>   |                  |
| 1 LED/3 LED Screw, #4-40 x 3/8" (Qty Req: 2)                              | 762400           |

### Beam Angle Lens Chart

| DESCRIPTION                    | PART #        |
|--------------------------------|---------------|
| <b>Round Beam Angle Lenses</b> |               |
| 1 LED Spot Lens (20°)          | 770600        |
| 1 LED Flood Lens (35°)         | 1LED-FL-LENS  |
| 1 LED Wide Flood Lens (60°)    | 1LED-WFL-LENS |
| 3 LED Spot Lens (20°)          | 771300        |
| 3 LED Flood Lens (35°)         | 3LED-FL-LENS  |
| 3 LED Wide Flood Lens (60°)    | 3LED-WFL-LENS |

### 1st Gen LED Chart

| DESCRIPTION   | PART #          |
|---|-----------------|
| <b>LED Replacement Kits</b> (Board, Reflector, Screws, Color Filters) |                 |
| 1 LED Up Light Kit (3900K)  | 1LED-UL-KIT     |
| 3 LED Up Light Kit (3900K)  | 3LED-UL-KIT     |
| ZD 1 LED Up Light Kit (3900K)   | ZD-1LED-UL-KIT  |
| ZD 3 LED Up Light Kit (3900K)   | ZD-3LED-UL-KIT  |
| ZD 3 LED T Up Light Kit (TURTLE)                                      | ZD-3LED-T-KIT   |
| <b>Color Filter Lenses Only</b>                                       |                 |
| 1 LED Color Filter, Amber   | 770100          |
| 1 LED Color Filter, Blue  | 770101          |
| 1 LED Color Filter, Green   | 770102          |
| 3 LED Color Filter, Amber   | 770800          |
| 3 LED Color Filter, Blue  | 770801          |
| 3 LED Color Filter, Green   | 770802          |
| <b>Optics Kits</b> (Reflector, Screws, Color Filters)                 |                 |
| 1 LED Optics Kit  | 1LED-OPTICS-KIT |
| 3 LED Optics Kit  | 3LED-OPTICS-KIT |