

DESIGNER | UP LIGHT | FB LED

Replacement Parts

ITEM	DESCRIPTION	CATALOG #
1	Shroud	-
2	Lens, Clear	-
1-2, 13	Lens Cap Assembly (Clear)	FBLCXX**
3-4	Beam Angle Lens	See LED Chart
5-6	Color Filter	See LED Chart
7	Screw, #4-40 x 3/8"	See LED Chart
8-9	Reflector	See LED Chart
10-11	LED Board	See LED Chart
12	Socket, 3-meter	752601
13	O-Ring	250010280017
14	Body	†
15	Base	†
16	O-Ring	250010280002
17	Screw, #10-24 x 3/8"	250013940000
18	Screw, 1/4"-20 x 3/4"	250010290000
19	Knuckle Subassembly	KFM050XX*
20	Super Slot Spike	753900
21	Stainless Steel Bracket	250026820000
22	Strain Relief Connector	250026840000
23	Bracket Mount Knuckle Base	-
21-23	Bracket Mount Assembly	BM050XX*
24	Lock Ring	250030410000

* XX = Finish code

** Replace "C" with "F" for frosted lens option

† This part is not serviceable. Contact Customer Support or a local distributor to order a new product.

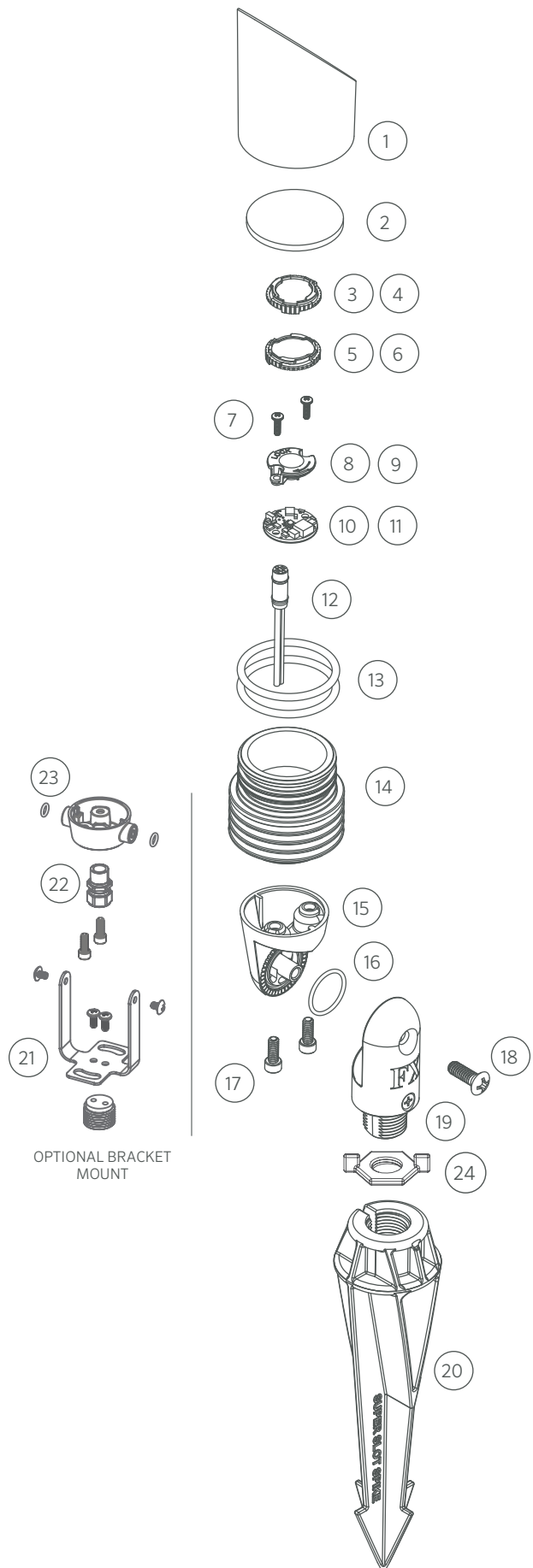

LED Chart

ITEM	DESCRIPTION	CATALOG #
3	1LED Spot Lens (18°)	770600
3	1LED Flood Lens (30°-32°)	1LEDFLENS
3	1LED Wide Flood Lens (56°-58°)	1LEDWFLENS
4	3LED Spot Lens (18°)	771300
4	3LED Flood Lens (30°-32°)	3LEDFLENS
4	3LED Wide Flood Lens (56°-58°)	3LEDWFLENS
5	1LED Color Filter, Amber	770100
5	1LED Color Filter, Blue	770101
5	1LED Color Filter, Green	770102
6	3LED Color Filter, Amber	770800
6	3LED Color Filter, Blue	770801
6	3LED Color Filter, Green	770802
7	1LED/3LED Screw, #4-40 x 3/8" (Qty Req: 2)	762400
8	1LED Reflector	770000
9	3LED Reflector	770700
9	ZDC Reflector	250022050000
10	1LED Board	1LEDULKIT [†]
11	3LED Board	3LEDULKIT [†]
11	ZDC LED Board	ZDCKITM ^{**}

[†] ZD = Zoneable and dimmable (add ZD to front of part number)

^{**} ZDC kit includes LED board, reflector (#9), screws (#7), and flood lens diffuser (3LEDWFLENS)