

The Low-Voltage Dimmer provides in-line dimming control for any low-voltage fixture. It's the ideal accessory for all landscape lighting systems that require dimming capabilities. The product is designed for installation in standard junction boxes, as well as in the field, for maximum flexibility.

FEATURES

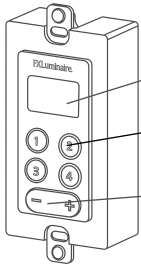

Backlit Display

Displays current dimmer intensity value

Preset Buttons

Save custom intensity settings

Dimming Control

Increase or decrease system intensity



NOTE

Dimming levels are unique to each lighting fixture and lamp. Some lamps and fixtures may shut off prior to reaching 0% intensity.



NOTE

Visit the DIM-LV support page for a list of compatible junction boxes.

JUNCTION BOX INSTALLATION OPTIONS

1 INDOOR-RATED BOX

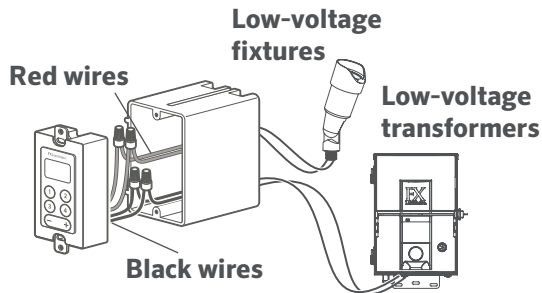

1. Connect field wires from transformer to dimmer wires (black). Connect fixture wires to dimmer wires (red).

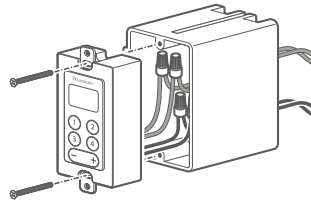

2. Install dimmer inside the junction box.

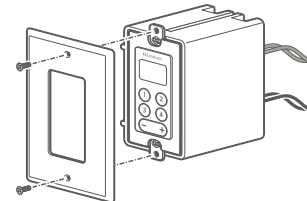

3. Install the faceplate (not included).

2 METAL OUTDOOR-RATED BOX

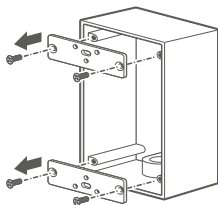

1. Remove existing brackets at the top and bottom of the junction box.

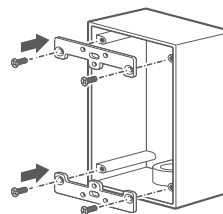

2. Install the included brackets into the junction box. Make sure that the brackets are oriented as shown.

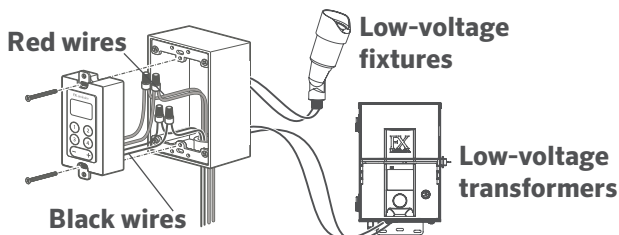

3. Connect field wires from transformer to dimmer wires (black). Connect fixture wires to dimmer wires (red).

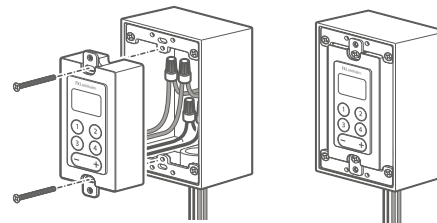

4. Install dimmer inside the junction box.

BASIC OPERATION

All fixtures wired to the dimmer will illuminate to the intensity set on the DIM-LV. When the lighting transformer is powered on (output low voltage to field), the dimmer will turn on the fixtures to the last set intensity value.

1. Turn on the lighting transformer and confirm that the DIM-LV display is illuminated. The LCD will display the last set intensity value. For new installs, the value will be 50%.
2. To adjust fixture intensity, use the + or - buttons to increase or decrease intensity. Pressing and holding down the + or - buttons increases the speed of adjustment.



NOTE

Dimming levels are unique to each lighting fixture and lamp. Some lamps and fixtures may shut off prior to reaching 0% intensity.

PRESET INTENSITY

The DIM-LV has four customizable intensity buttons (1, 2, 3, and 4). Preset intensities are shown in the table below.

To change preset intensity levels, follow the instructions below.

1. Set dimmer intensity to the desired level. See Basic Operations.
2. Press and hold down the desired preset button (1-4) for five seconds, or until the LCD quickly flashes OFF and then back ON.
The display flash indicates that the intensity level has been saved to the preset button.

TIP: Dedicate a preset button to 0% intensity. This button can be used as the dimmer OFF button.

Preset Button	Intensity Level
1	0%
2	50%
3	75%
4	100%

TROUBLESHOOTING

Issue	Solution
Fixtures turning off at intensity higher than 0%	<ul style="list-style-type: none"> • Dimming levels are unique to each LED lighting fixture and LED lamp. Some LED lamps and LED fixtures may shut off prior to reaching 0% intensity. • Determine the minimum dimming level for your fixtures by manually adjusting the intensity using the + or - buttons located at the bottom of the fixture.
LCD is not illuminated	<ul style="list-style-type: none"> • Confirm wiring per installation guide. Input field wires (wires installed into the transformer) must be wired to dimmer 12 V black "in" wires. • Confirm transformer is powered on (minimum 11 VAC).
Fixtures not turning on	<ul style="list-style-type: none"> • Confirm wiring per installation guide. Dimmer 12 V red "out" wires must be connected to field wires (wires installed into the fixtures). • Confirm fixtures are receiving the minimum 11 VAC operating voltage.

FCC statement:



This device complies with part 15 of the FCC Rules. Operation is subject to the following two conditions: (1) This device may not cause harmful interference, and (2) this device must accept any interference received, including interference that may cause undesired operation.

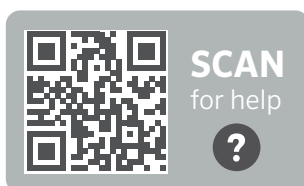

fxl.help/LVD



fxl.com/locations/distributor

We have developed this series of field installation guidelines to assist you in correctly installing fixtures and transformers, ensuring customer satisfaction and trouble-free service. If you have any questions, please call your local distributor before proceeding. Follow all NEC guidelines and local electrical codes.